



# ALTRAD GENERATION

HIRE & SALE



EDGE PROTECTION



# Altrad Generation Hire & Sale

Support for Construction & Industry

Altrad Generation is the UK's leading supplier of: Scaffolding, Temporary Fencing, Light Access, Edge Protection, Safety Decking and Groundworks for hire and sale.

## OUR CUSTOMER COMMITMENT IS TO DELIVER:



### BEST QUALITY

We work closely with our suppliers to ensure consistent product quality every time. All our products are specified to meet or exceed statutory requirements, verified by our Quality Assurance team.



### BEST AVAILABILITY

Our nationwide branch network, transport fleet and stock holding ensure we can supply your equipment needs. What, When and Where you need equipment.



### BEST PARTNERSHIP

We can take care of all your equipment needs; supplemented by a full range of engineering, design, specification and business services. Our focus is to work together, supporting the growth of your business.



### BEST VALUE

Our global supply chain, purchasing and lean business means we don't pass on unnecessary costs to you. We aim to provide consistently low prices and the best value when you buy or hire from us.

## Contents

### Edge Protection



Introduction .....	3-6
Steel Frame Solutions .....	7-8
Concrete Frame Solutions .....	9-12
Timber Frame Solutions .....	13-14
Staircase Solutions .....	15-18
Demarcation.....	19
Safeguard Roof Edge Protection.....	20
Lift Shaft Solutions .....	21
Access Gate Solutions .....	22
Service & Support.....	23-24

Talk to our dedicated Edge Protection team:  
[edgeprotection@generationuk.co.uk](mailto:edgeprotection@generationuk.co.uk)



#### Disclaimer

Whilst Generation (UK) Ltd has taken every reasonable effort to ensure the information contained within this publication is correct and complete at the time of printing, you should be aware that there will be periodical changes and Generation (UK) Ltd does not accept any liability for any inconvenience, loss or damage caused as a result of any inaccuracy or omission within this publication.

#### Copyright

No unauthorised reproduction of any images, text or other matter contained herein is permitted. All rights are expressly reserved, including copyright, design right, moral and patent rights (where applicable). We reserve the right to take legal action in respect of any infringement of said rights.



## Edge Protection



Altrad Generation's Rapid Edge Protection System is perceived to be one of the most comprehensive and effective systems in the market today. Designed and manufactured in the UK, our edge protection system offers a fast and efficient approach to site safety. We provide a full range of safe solutions for steel, concrete, and timber construction applications, offering huge benefits in safety, efficiency, and productivity, providing one of the quickest and most effective systems for protecting against falls from height.

All Edge Protection products are fully tested by Lloyds British test house and have been proven to meet and exceed the test requirements set out in BS EN 13374:2013 for Class A and Class B

When you source Edge Protection Solutions from Altrad Generation, you'll receive a fully comprehensive service which includes:

- Dedicated Edge Protection Account Manager: [edgeprotection@generationuk.co.uk](mailto:edgeprotection@generationuk.co.uk)
- Detailed quote with technical drawings.
- Optional additional detailed drawings, including phasing and indexing to save you time on-site
- On-site product familiarisation.
- On-site support, including installation and erection checks.
- Comprehensive installation guides.
- Edge Protection Federation accredited courses available.
- Readily available stock with our network of branches across UK.
- Fast and flexible delivery via our fleet of lorries, fitted with Hiab cranes.
- Uniformed pricing and credit facilities.

**How Does it Work?**



**Scan To View  
Our Videos.**



## Edge Protection

### Why Choose us?

#### The Rapid Post

- Faster than other similar systems on the market, this revolutionary on piece post can be installed in 3 easy steps.
- 10 times faster than traditional drill and fix solutions, with no drilling required, the rapid compression post gives significant savings on time, labour with no repairs.
- The post coupled with the rapid panel gives unrivalled economics in speed off erection.
- Offering Single, double or full height Edge Protection for a variety of containment solutions.
- Anti-tamper device for increased safety

#### The Rapid Panel

- This robust panel exceeds all safety standards set out in BS EN13374 : 2013 Class A & Class B.
- The biggest panel on the market today, at 2.9m, offering unrivalled fixing centres of 2.7m.
- 2.7m fixing centres covers more area, which saves on material and labour costs.
- It comes in three sizes of 2.9m 1.4m and 665m to give the flexibility required for modern building methods today.

#### The Rapid Work Through Panel

- This revolutionary panel offers the safe facility to reach through the panel and access the perimeter without compromising their safety, providing increased productivity.
- The only panel of its kind on the market today.





## Edge Protection

### Edge Protection Panel

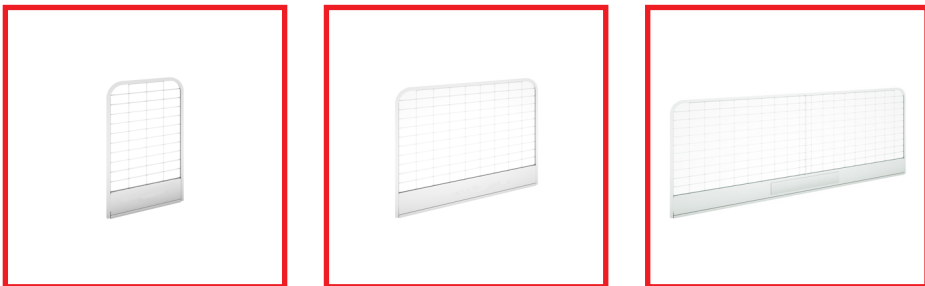

The robust design ensures that the system not only meets but exceeds all global safety standards and with unrivalled fixing centres of 2.7m.

Code	Description	Size (L X H)	Weight
450064	EP Panel Quarter	655mm - 1065mm	9.50kg
450006	EP Panel Half	1400mm - 1065mm	12.00kg
450004	EP Panel Full	2900mm - 1065mm	21.50kg

### Edge Protection Work Through Panel

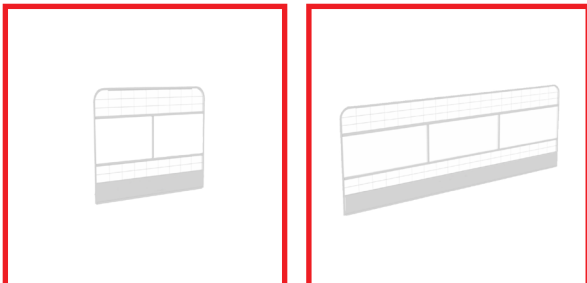

The simple but efficient patent pending barrier system provides the facility for operatives to safely reach through the panel to access the perimeter of the building without compromising their safety.

Code	Description	Size (L X H)	Weight
450121	Half Panel	1400mm - 1065mm	13.50kg
450111	Full Panel	2900mm - 1065mm	26.50kg

### System Loading Available on Request.

For added protection all new panels are shipped in purpose built stackable transportation aids to ensure the product is in pristine condition on arrival.

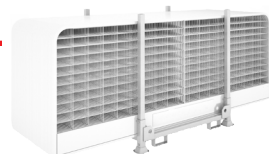

## Edge Protection Ltd System Testing, Class A & Class B

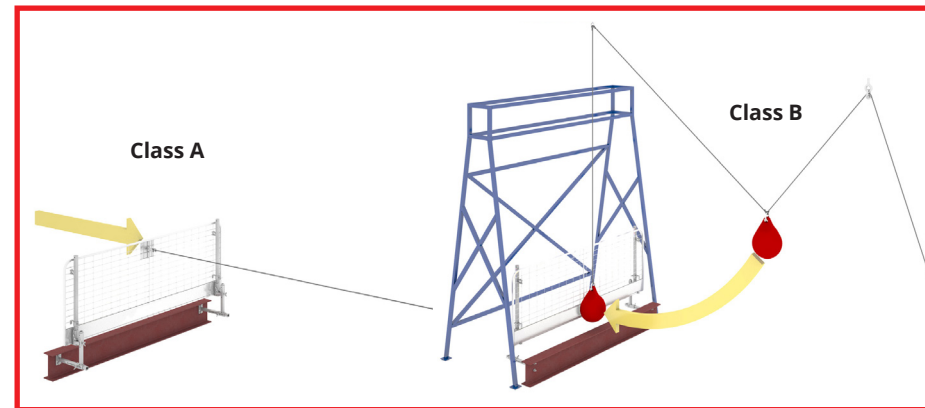

### Class A

The Edge Protection must resist a horizontal force of 0.3kN whilst maintaining elastic deflection within 55mm. The top guardrail must also accept a vertical force of 1.25kN applied as an accidental loading. The Edge Protection System has had numerous static loads applied up to four times this requirement.

### Class B

The edge protection must resist the same static loading requirements for Class A and additionally must pass a low dynamic impact test using a specifically designed test rig and impact sphere. This test applies impact energy of 0.5KJ to the top rail and 1.1KJ to the lower areas.

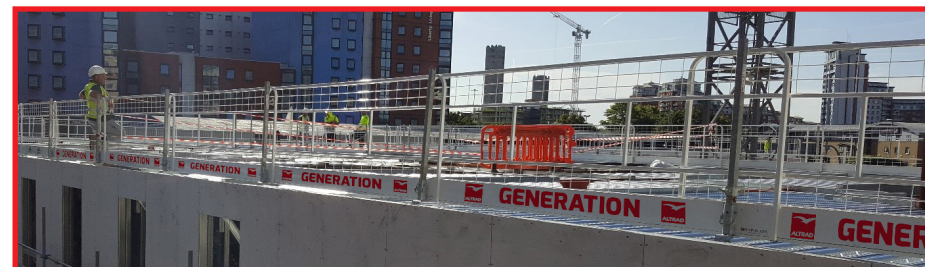



## Steel Frame Solutions

Altrad Generation is a leading supplier of solutions for fixing to Steel Structures. We can provide solutions that can be installed at ground level which means we can vastly reduce the risks involved with working at height. The Brackets we can supply you with are easily adjustable making it simple for following trades to continue their on-site work. Altrad Generation provides one of the longest Mesh Panels available on the UK market, we are able to offer fixing centres of up to 2.7m meaning fewer components are required which vastly reduces the installation time.



### Web Fix

The most popular method of fixing to the steel frame is by utilising the versatile web fix bracket. The bracket offers a vertical and horizontal indexing facility and positioning of the fixing holes for the bracket would be modelled by our technical team by using the most up to date software packages.

Code	Description	Size	Weight
450035	Web fix	510mm x 560mm	7.50kg



### Web Fix Brackets

Web Fix Extension Brackets increase the capabilities of the standard range from 560mm, out to 1300mm.

Code	Description	Size	Weight
450082	Web Fix Extension Bracket	200mm	1.80kg
450083	Web Fix Extension Bracket	400mm	3.20kg



### Support Post for Steel Frame

The versatile Support Post is compatible with all systems. Commonly used alongside the Web Fix Bracket, Sacrificial Socket and Bolt-on Socket.

Code	Description	Weight
450051	Support Post	9.5kg



## Steel Frame Solutions



### I-Beam Clamp

The solution is used for areas where web fix or sockets are not suitable or where edge protection requirements have not been considered at an earlier stage.

Again, utilising standard Barrier Panels and Support Posts, the system is fully compliant with global safety standards.

Code	Description	Size	Weight
450018	I-Beam Clamp	15mm - 665mm	12.50kg



### Bolt On Socket

The Bolt on Socket system is commonly used on steel frames and requires the steelwork contractor to bolt the socket to the top of the perimeter beam at centres specified by our technical team.

Utilising the steel frame support post and Rapid Panel, the installation can be carried out swiftly and safely at ground level.

Code	Description	Size	Weight
450099	Bolt on Socket	182mm	1.50kg

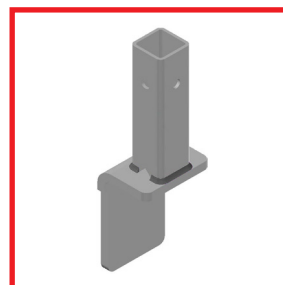

### Metsec Pocket Bracket

This simple but effective Metsec Bracket solution, has been designed to provide a quick and easy method of providing an edge protection to light-gauge steel framing systems (SFS). The system is attached to the light gauge steel using a preinstalled pocket, that the Metsec Bracket is installed into, followed by the Supporting Post and Work Through Panel.

Code	Description
450119	Metsec Pocket Bracket



### Sacrificial Socket

The Sacrificial Socket system is commonly used on steel frames and requires the steelwork contractor to weld the socket to the perimeter beam at centres specified by our technical team.

Utilising the steel frame support post and Rapid Panel, the installation can be carried out swiftly and safely at ground level.



## Concrete Frame Solutions



Altrad Generation provides edge protection solutions for concrete frames including systems that don't require any penetrating into the concrete at all. The Rapid Post is a telescopic post that offers single, extended and full containment edge protection using very few components which vastly reduces the installation process.

This unique and innovative product is proven to be up to 10 times faster than existing drill & fix systems with typically 20 metres being erected in less than 10 minutes. As well as the Rapid Post, Altrad Generation can also provide systems that drill & fix into the top of the slab, into the slab edge as well as Clamping systems.

### Rapid Post & Rapid Post Extra



#### Post:

The innovative Rapid Post, with its ease of installation and overall performance, has become a default safety solution for many companies around the world.

- 10x faster than traditional drill and fix systems.
- No tools required! No drilling or fixings.
- Minimal training required.
- Fully compliant with BSEN 13374:2013 for Class A and B Protection.
- Zero penetration of the concrete.
- Ideal for post tension slabs.
- Compression mechanism guaranteed for two million cycles.
- Safety device on post clearly indicates correct assembly.
- Single, extended or full containment edge protection for total enclosure.
- Rapid Post extends up to 3.4 metres.
- Extend height by attaching Clamps.

#### Post Extra:

Longer post extends up to 4.3 metres  
The same benefits as Rapid Post

Code	Description	Size	Weight
450001	Rapid Post	2000mm - 3400mm	12.00kg
450002	Rapid Post Extra	2900mm - 4300mm	19.00kg



## Concrete Frame Solutions

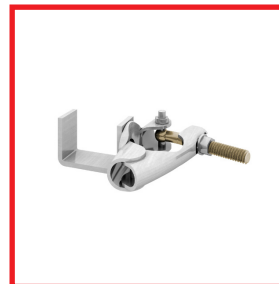

### Rapid Clamp & Latch

Add Clamps or Latches for full height Edge Protection.

Code	Description	Weight
450014	Post Clamp	0.50kg
450015	Post Latch	0.50kg



450091

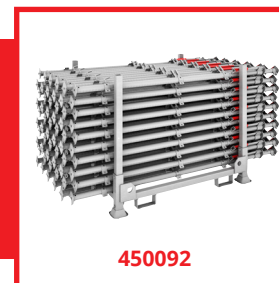

450092

For added protection, all new Rapid Posts and ancillaries are shipped in purpose built stackable transportation aids to ensure the product is in pristine condition on arrival.

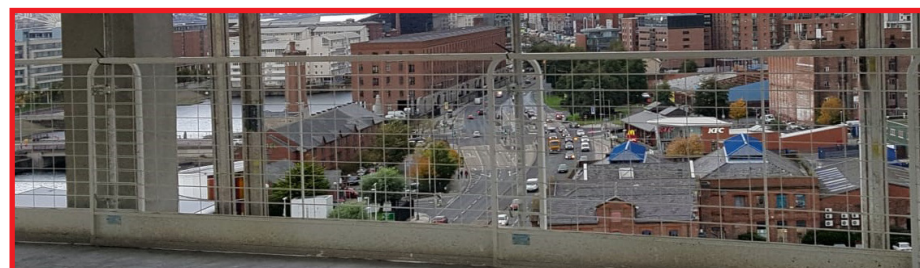



## Concrete Frame Solutions



### Dual Purpose Stand

The Dual Purpose Stand has been fully tested and proven to exceed global safety standards for Edge Protection/Fall Prevention. Along with a galvanised finish come:

- Installed in just minutes with two anchor bolts
- Available in standard and dual height options
- 2.7m fixing centres

Code	Description	Size	Weight
450008	Dual Purpose Stand	1120mm	6.00kg
-	Dual Purpose Stand Extra	2200mm	13.00kg



### Concrete Socket Base

The Concrete Socket Base can be installed on any concrete surface either at a pre-cast stage using inserts, or by drilling and installing later.

Code	Description	Size	Weight
450011	Concrete Socket Base	150mm	1.50kg



## Concrete Frame Solutions



### Slab Grab

A fully tested solution where Rapid Post or drill and fix solutions are precluded.

- Adjustable height on floor slabs: 150mm - 760mm thickness
- Robust tensioning facility
- Install a safe working area in minutes

Code	Description	Size	Weight
450009	Slab Grab	375mm	10.50kg



### Curb Grab

This simple but very robust solution uses the standard support post and has been tested to exceed global safety standards.

- Robust tensioning facility
- Adjustment range 150mm - 560mm
- Allows fixing to problematic areas including bridge work & parapets with upstands of up to 560mm

Code	Description	Size	Weight
450010	Curb Grab	150mm - 620mm	9.00kg





## Timber Frame Solutions



Altrad Generation provides a full range of components for hire for the timber frame edge protection. Like with our steel frame edge protection, you can install our components for Timber Frames on the ground making installation safer and more efficient. We are also able to supply you with top fix solutions and side fix solutions and handrails or mesh barriers can be used.



### Timber Socket Base

Surface fix only needs three or four fixings depending on which option you require. Fix timber socket base using 3no. Ø8/3 8 X 80mm/31 8" heco topix screw.

Code	Description	Size	Weight
450085	Timber Socket Base	181mm	1.50kg



### Universal Face Mount Bracket

Face fix only requires five Hecotopix screws into timber or alternatively can be used on concrete using 2 x M16 thunder bolts. (supplied by others). Screw 5no. 80mm/3 8" Hecotopix screws into holes.

Code	Description	Size (W X D X H)	Weight
450089	Universal Face Mount Bracket	200mm x 150mm x 100mm	1.00kg



### Dual Purpose Stand

The Dual Purpose Stand has been fully tested and proven to exceed global safety standards for Edge Protection/Fall Prevention. Along with a galvanised finish come:

Installed in just minutes with two anchor bolts  
Available in standard and dual height options  
2.7m fixing centres

Code	Description	Size	Weight
450008	Dual Purpose Stand	1120mm	6.00kg



## Timber Frame Solutions

### Handrails System

We have a selection of Handrails spanning from 280mm to 3000mm to cope with any configuration.

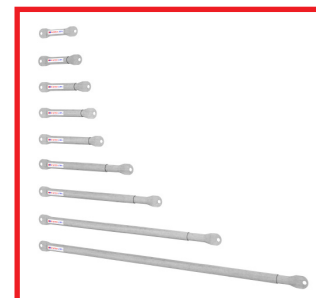

Code	Description	Size	Weight
450066	Handrails System - SR0	280mm - 300mm	1.00kg
450048	Handrails System - SR1	390mm - 440mm	1.00kg
450055	Handrails System - SR2	440mm - 500mm	1.50kg
450056	Handrails System - SR3	500mm - 590mm	2.00kg
450057	Handrails System - SR4	590mm - 720mm	2.50kg
450026	Handrails System - SR5	720mm - 930mm	3.00kg
450049	Handrails System - SR6	930mm - 1300mm	5.00kg
450025	Handrails System - SR7	1300mm - 2000mm	7.00kg
450050	Handrails System - SR8	1900mm - 3000mm	11.00kg

### Adapter Face Plate

Web fix bracket (with four fixings using adapter face plate) incremental indexing facility to cater for overhangs in excess of 900mm.

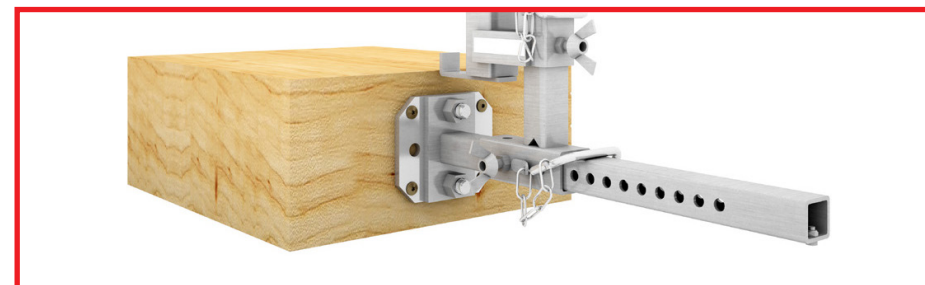

Code	Description	Size (V X H)	Weight
450034	Adapter Face Plate	140mm x 160mm	1.50kg





## Staircase Solutions



Protecting Staircases can be a challenging task as dimensions can vary. All of our Staircase solutions are supplied with unique Telescopic handrails meaning there is no need to cut down traditional tubes to the required sizes.

We can provide timber staircase and concrete staircase solution's with multiple fixing methods including drill & fix, clamping, Rapid Post & pre-cast options.

With our pre-cast and drill & fix components, we can also supply unique telescopic debris guards meaning we can offer full edge protection down the flights, landings & half-landings including returns.



### Stairwell Clamp

The Stairwell Clamp can be quickly installed on to precast stair, when drill and fix is not an option, this product is used in conjunction with the newel post and the adjustable handrail giving a speedy solution.

Code	Description	Size	Weight
450024	Stairwell Clamp	100mm - 300mm	7.50kg



### Stair Rail Connector Bracket

The Stair Rail Connector Bracket can be quickly installed on any post installed on a landing to provide handrails when speed is a necessity.

Code	Description
450027	Stair Rail Connector Bracket



## Staircase Solutions



### Newel Posts

There are 3 Stairwell Posts to suit every eventuality.

The regular Stairwell Post has antiluce fitting on a single side and the right and left posts have fittings facing out at 90 degrees.

Code	Description	Size	Weight
450021	Newel Post	1100mm	4.00kg
450022	Newel Post - Left	1100mm	4.00kg
450023	Newel Post - Right	1100mm	4.00kg



### Concrete Socket Base

The Concrete Socket Base can be installed on any concrete stair, either at a precast stage using inserts, or by drilling and installing later.

Code	Description	Size	Weight
450011	Concrete Socket Base	150mm	1.50kg

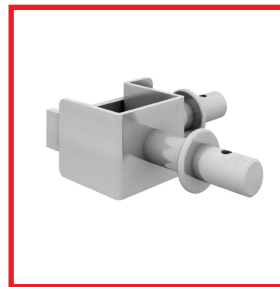

### Debris Board Connector Bracket

Code	Description	Weight
450044	Debris Board Connector Bracket	0.50kg



### Centre Post Clip

Code	Description	Weight
450054	Centre Post Clip	0.50kg



## Staircase Solutions

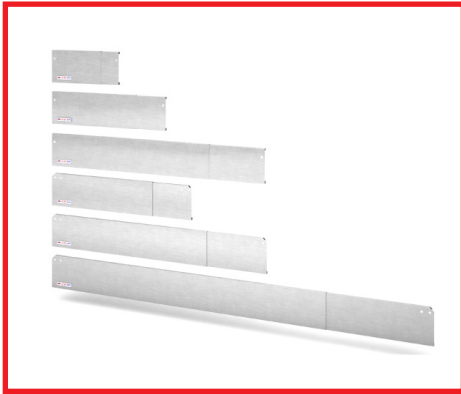

### Debris Guards - Landing & Stairs

As an added feature, most of the Edge Protection stair system can be upgraded with Debris Guards which come in a range of lengths.

Code	Description	Size	Weight
450052	Debris Guards - DGL1	390mm - 560mm	2.00kg
450058	Debris Guards - DGL2	560mm - 900mm	3.50kg
450059	Debris Guards - DGL3	900mm - 1580mm	6.00kg
450060	Debris Guards - DGL4	1580mm - 2890mm	10.50kg
450046	Debris Guards - DGS1	1320mm - 1920mm	7.00kg
450038	Debris Guards - DGS2	2940mm - 1820mm	10.50kg
450042	Debris Guards - DGS3	2820mm - 4940mm	19.00kg



## Staircase Solutions

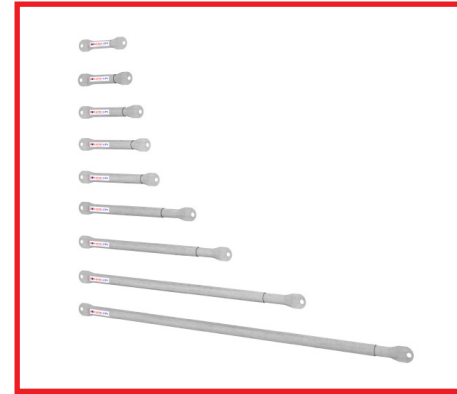

### Stair Handrails

We have a selection of Handrails spanning from 280mm to 3000mm to cope with any configuration.

Code	Description	Size	Weight
450066	Stair Handrail - SR0	280mm - 300mm	1.00kg
450048	Stair Handrail - SR1	390mm - 440mm	1.00kg
450055	Stair Handrail - SR2	440mm - 500mm	1.50kg
450056	Stair Handrail - SR3	500mm - 590mm	2.00kg
450057	Stair Handrail - SR4	590mm - 720mm	2.50kg
450026	Stair Handrail - SR5	720mm - 930mm	3.00kg
450049	Stair Handrail - SR6	930mm - 1300mm	5.00kg
450025	Stair Handrail - SR7	1300mm - 2000mm	7.00kg
450050	Stair Handrail - SR8	1900mm - 3000mm	11.00kg

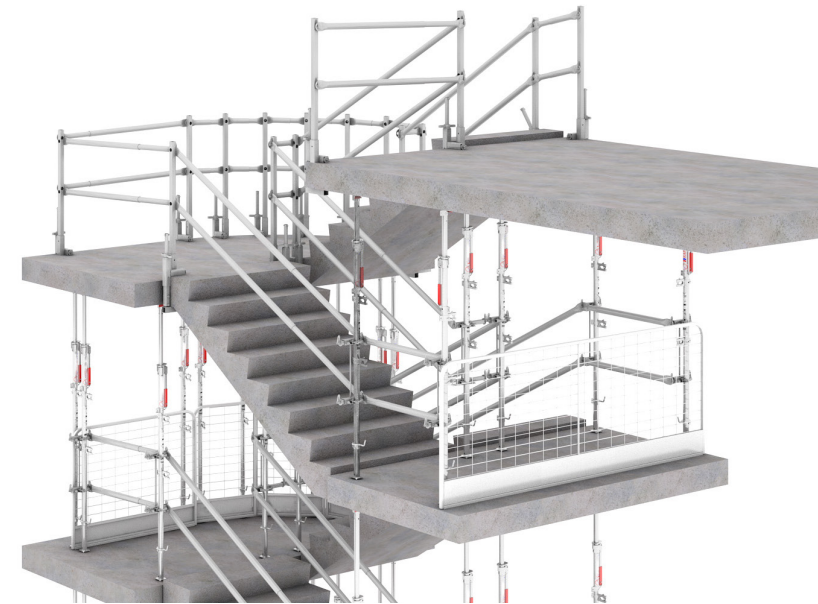



## Demarcation

Utilising the same three free standing components, safe compounds for use as waste disposal or storage areas can be created in just minutes.



### Footplate

Utilising the Hi-Vis Footplate and Standard Support Post, free standing demarcation can be swiftly installed.

Code	Description	Size	Weight
450028	Footplate	900mm - 300mm	3.00kg

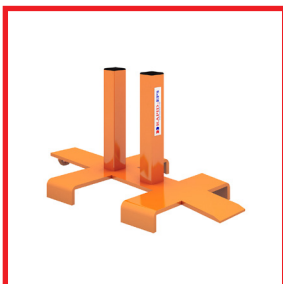

### Ballast Bracket

With the addition of the Ballast Bracket and some "off the shelf" ballast blocks, you can convert EP freestanding demarcation into Class A Edge protection.

Code	Description
450084	Ballast Bracket



Free standing countered weighted Edge Protection can be installed quickly and easily by attaching the purpose designed ballast bracket to the flexible Hi-Vis Footplate.

Free standing Edge Protection systems derive their support from weighted components fixed to additional supporting systems which can be positioned on flat surfaces within at least 2 metres of the edge of a fall area.

Like all Edge Protection systems, the free standing solution has been tested at the unique 2.7m centres and has been proven to meet the requirements for a Class A system as laid down in the standard BS EN 13374: 2013.



## Safeguard Roof Edge Protection



The totally versatile, safe and easy to assemble Temporary Roofing Guardrail System that saves you time and money. Using standard scaffold tubes it provides the most cost effective solution for a professional guardrail.

Adjustable front and back legs ensure that guard rail is positioned at the correct height. When installed individual legs can be raised to accommodate felt laying and dressing with a facility for Toeboards built in.



Altrad Generation's Safeguard System is approved to the Class A requirements for sloping roofs less than 10 degrees and additionally, as an added safety measure, we have tested and fulfilled the Dynamic Load Test to Class B of BS EN 13374:2004 to give further confidence for example, in the event of a person stumbling into the barrier.

Code	Description	Weight
369300	Safeguard Frame	17.00kg
369301	Safeguard 25kg Weight	25.00kg

### Weights positioning

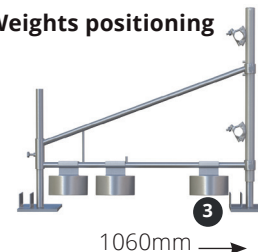

- 1 Used for all bays
- 2 Used for all end frames
- 3 Used for all end frames If the slope is  $>3 / \leq 9^\circ$



## Lift Shaft Solutions



The solution utilises light but extremely robust and user friendly components and features a secure key activated locking gate. Standard EP components such as the innovative Post and Panel are utilised when completely securing the protected areas and with no need for any penetration of the working surface, multiple lift / elevator shafts are protected in just minutes.



### Lift Shaft Gates

The unique Lift Shaft/Elevator Gate offers protection to multiple core openings with just one Lift Shaft/Elevator Gate. As with all EP components, the Lift Shaft / Elevator Gate has been certificated by Lloyds British in line with BS EN 13374:2013.

Code	Description	Size	Weight
450033	Lift Shaft Gate	2240mm - 700mm	38.00kg

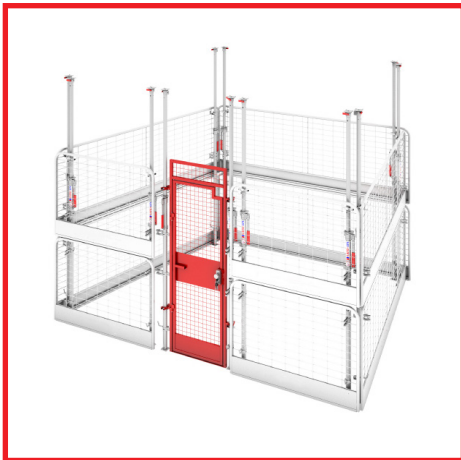

### Offering a Whole New Approach to Lift Shaft/Elevator Safety

Using standard EP components, in conjunction with a Lift Shaft/Elevator Gate, a secure compound can be built to protect valuables and control access.



## Access Gate Solutions



### Access Gate - Socket Base

A gate which can be dropped into Adjustable Slab Edge brackets and provides safety during access to the construction zone, complete with an auto-closing mechanism and Rapid Latch which secures the gate when shut.

Code	Description	Weight
450032	Access Gate - Socket Base	23kg

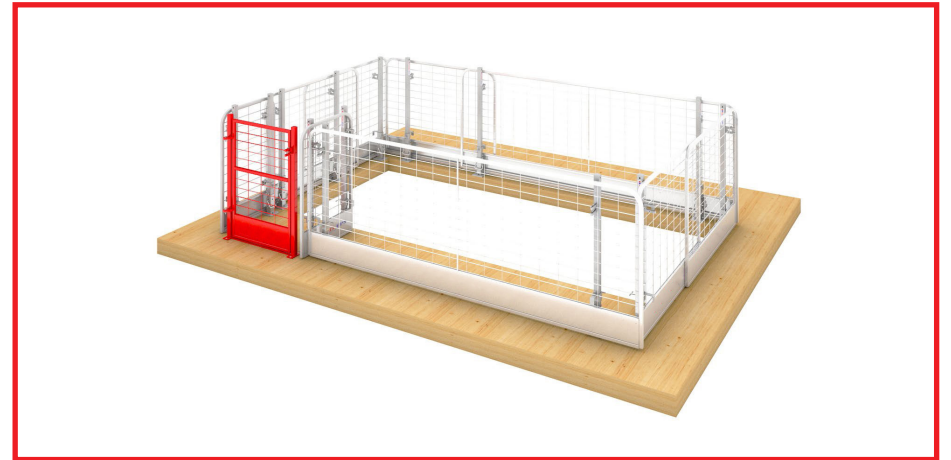



## Technical Service & Support

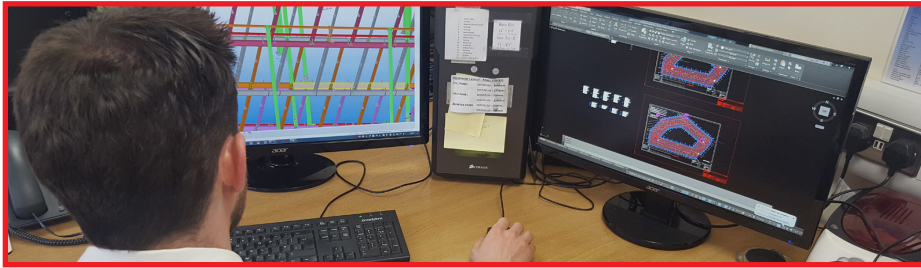

Using the most up to date detailing software available, our dedicated technical advisors are on hand to ensure your project is in safe hands.

### Project Management

Offering expert advice from enquiry stage through to supplying the equipment, the technical team are dedicated to sorting out potential fall prevention problems on the drawing board and not on site.

### Training

In house industrial training is available on request at our manufacturers training centre in Leeds, product training and training covering the standard for Temporary Edge Protection Systems, BS EN 13374 is available to all customers.



## Technical Service & Support

### Step 1 - Assessment

On receipt of drawings, the team will make assessments of the areas to be protected. This process acts as a working brief and ensures any potential problem areas are considered and discussed at the early stage of the enquiry. This assists in making sure the most suitable and efficient solution is supplied.

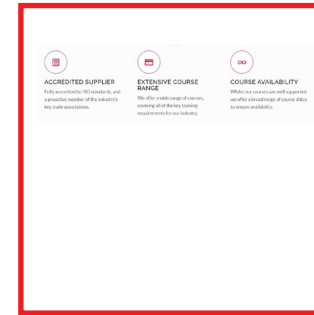

### Step 2 - Quotation

A quotation will be prepared with the areas to be protected, the general quantity of perimeter edge protection required. This process offers the client the opportunity to question the installation requirements and consider the overall project costs.

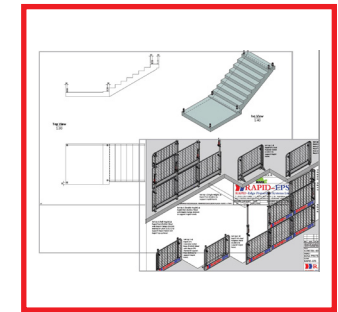

### Step 3 - Detailing

On instruction to proceed, the technical team will produce the detailing requirements and final positioning of the edge protection solutions. Supporting guidance and drawings can be supplied at this stage which will assist the installers with positioning the correct equipment in the correct areas.

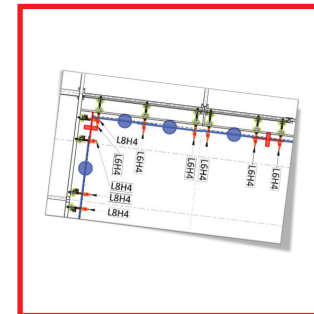

### Step 4 - Supply

On instruction from the client, the deliveries of equipment will be made to site in a phased manner and at a time to suit site activity. This ensures you are getting what you need, when you need it. Project management and site support is on hand from the start of your project until completion.





**SCAN ME  
TO FIND**



**YOUR LOCAL  
BRANCH**



**GENERATION  
HIRE & SALE**

Generation UK Ltd.  
Head Office, Trinity Street, Off Tat Bank Road, Oldbury, West Midlands, B69 4LA - United Kingdom  
Tel. 0121 543 2950 - Fax. 0121 543 2953 - [enquiries@generationuk.co.uk](mailto:enquiries@generationuk.co.uk)  
[www.altradgeneration.com](http://www.altradgeneration.com)